

eurofins
Environment Testing
America

Phone: 912-354-7858 Fax: 912-352-0165

1. 3 Compartment Sink
2. Food Prep Sink
3. Steamer
4. Kettle
5. Braising Pan

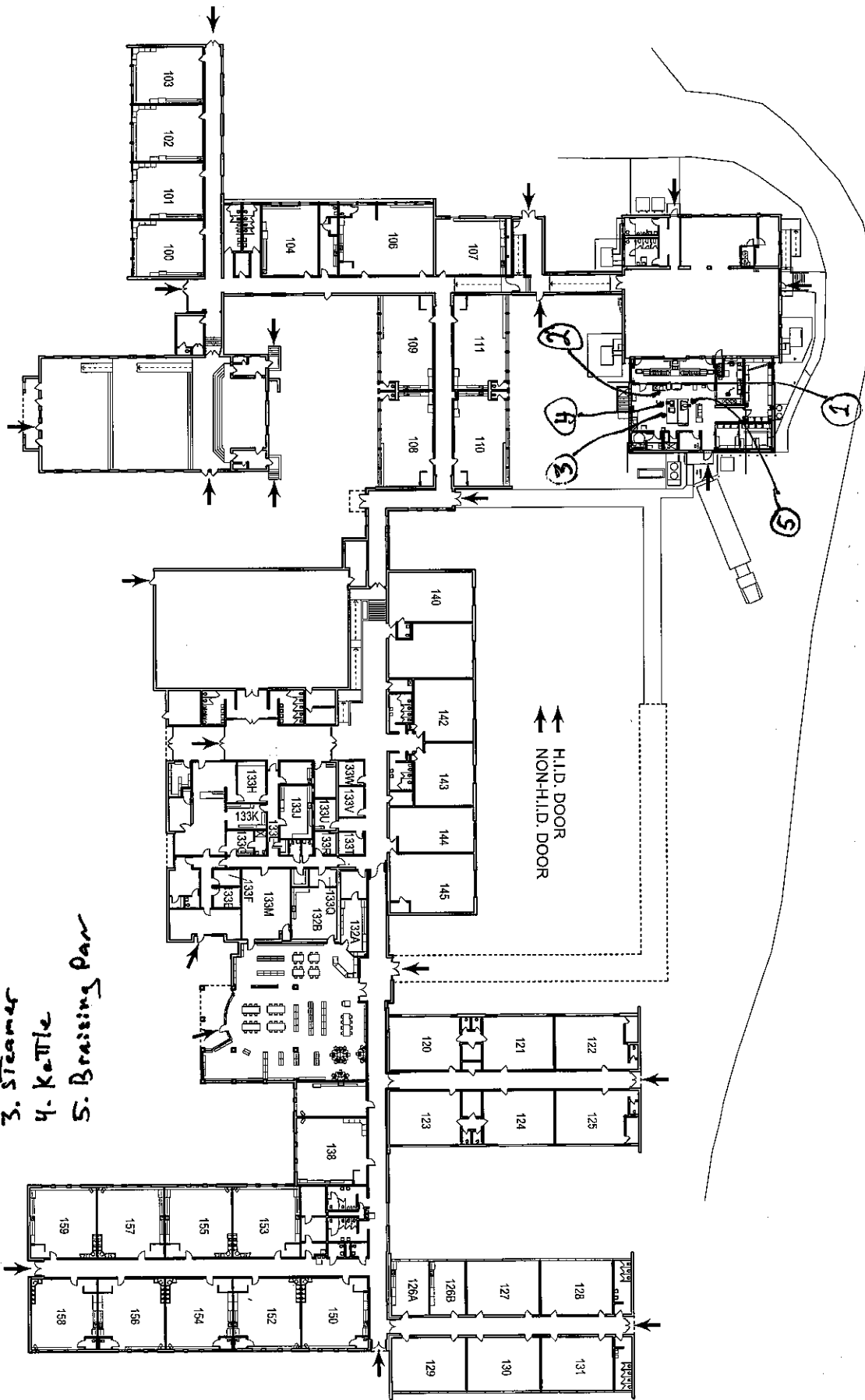

FLOOR

REVISIONS	DATE	BY	SCALE
1	12/12/2014		

PAGE TITLE: FLOOR PLANS
 PROJECT DESCRIPTION: PROPERTY ACCOUNTING SITE SURVEY

INDIAN TRAIL
 ELEMENTARY SCHOOL
 200 EDUCATION RD
 INDIAN TRAIL, NC 28079

UCPS
 UNION COUNTY PUBLIC SCHOOLS
 Globalization. Innovation. Graduation.

Client Sample Results

Client: Union County Public Schools
Project/Site: Lead in Drinking Water - Indian Trail

Job ID: 680-197605-1

Client Sample ID: Indian Trail 3 Compartment Sink

Lab Sample ID: 680-197605-1

Date Collected: 04/05/21 15:00

Matrix: Water

Date Received: 04/14/21 12:30

Method: 200.8-1994 R5.4 - Metals (ICP/MS)

Analyte	Result	Qualifier	RL	MDL	Unit	D	Prepared	Analyzed	Dil Fac
Lead	0.060	U	0.30	0.060	ug/L		04/15/21 12:15	04/15/21 15:44	1

5

Client Sample ID: Indian Trail Food Prep Sink

Lab Sample ID: 680-197605-2

Date Collected: 04/05/21 15:03

Matrix: Water

Date Received: 04/14/21 12:30

Method: 200.8-1994 R5.4 - Metals (ICP/MS)

Analyte	Result	Qualifier	RL	MDL	Unit	D	Prepared	Analyzed	Dil Fac
Lead	0.24	J	0.30	0.060	ug/L		04/15/21 12:15	04/15/21 15:38	1

Client Sample ID: Indian Trail Steamer

Lab Sample ID: 680-197605-3

Date Collected: 04/05/21 15:07

Matrix: Water

Date Received: 04/14/21 12:30

Method: 200.8-1994 R5.4 - Metals (ICP/MS)

Analyte	Result	Qualifier	RL	MDL	Unit	D	Prepared	Analyzed	Dil Fac
Lead	0.36		0.30	0.060	ug/L		04/15/21 12:15	04/15/21 15:41	1

Client Sample ID: Indian Trail Kettle

Lab Sample ID: 680-197605-4

Date Collected: 04/05/21 15:10

Matrix: Water

Date Received: 04/14/21 12:30

Method: 200.8-1994 R5.4 - Metals (ICP/MS)

Analyte	Result	Qualifier	RL	MDL	Unit	D	Prepared	Analyzed	Dil Fac
Lead	0.36		0.30	0.060	ug/L		04/15/21 12:15	04/15/21 15:08	1

Client Sample ID: Indian Trail Braising Pan

Lab Sample ID: 680-197605-5

Date Collected: 04/05/21 15:16

Matrix: Water

Date Received: 04/14/21 12:30

Method: 200.8-1994 R5.4 - Metals (ICP/MS)

Analyte	Result	Qualifier	RL	MDL	Unit	D	Prepared	Analyzed	Dil Fac
Lead	0.36		0.30	0.060	ug/L		04/15/21 12:15	04/15/21 15:29	1

Eurofins TestAmerica, Savannah

Client Sample Results

Client: Union County Public Schools
Project/Site: Lead in Drinking Water - Indian Trail

Job ID: 680-190817-1

Client Sample ID: Indian Trail 1

Date Collected: 10/17/20 09:00

Date Received: 10/30/20 13:30

Lab Sample ID: 680-190817-1

Matrix: Water

Method: 200.8-1994 R5.4 - Metals (ICP/MS)

Analyte	Result	Qualifier	RL	MDL	Unit	D	Prepared	Analyzed	Dil Fac
Lead	0.12	J	0.30	0.060	ug/L		11/03/20 12:53	11/04/20 13:08	1

Client Sample ID: Indian Trail 2

Date Collected: 10/17/20 09:01

Date Received: 10/30/20 13:30

Lab Sample ID: 680-190817-2

Matrix: Water

Method: 200.8-1994 R5.4 - Metals (ICP/MS)

Analyte	Result	Qualifier	RL	MDL	Unit	D	Prepared	Analyzed	Dil Fac
Lead	0.31		0.30	0.060	ug/L		11/02/20 13:44	11/02/20 17:09	1

Client Sample ID: Indian Trail 3

Date Collected: 10/17/20 09:02

Date Received: 10/30/20 13:30

Lab Sample ID: 680-190817-3

Matrix: Water

Method: 200.8-1994 R5.4 - Metals (ICP/MS)

Analyte	Result	Qualifier	RL	MDL	Unit	D	Prepared	Analyzed	Dil Fac
Lead	0.060	U	0.30	0.060	ug/L		11/02/20 13:54	11/02/20 19:05	1

Client Sample ID: Indian Trail 4

Date Collected: 10/17/20 09:03

Date Received: 10/30/20 13:30

Lab Sample ID: 680-190817-4

Matrix: Water

Method: 200.8-1994 R5.4 - Metals (ICP/MS)

Analyte	Result	Qualifier	RL	MDL	Unit	D	Prepared	Analyzed	Dil Fac
Lead	0.074	J	0.30	0.060	ug/L		11/02/20 13:54	11/02/20 19:08	1

Client Sample Results

Client: Union County Public Schools
Project/Site: Lead in Drinking Water - Indian Trail

Job ID: 680-191950-21

Client Sample ID: Indian Trail 5

Date Collected: 11/21/20 08:30

Date Received: 11/25/20 15:00

Lab Sample ID: 680-191950-72

Matrix: Water

Method: 200.8-1994 R5.4 - Metals (ICP/MS)

Analyte	Result	Qualifier	RL	MDL	Unit	D	Prepared	Analyzed	Dil Fac
Lead	0.19	J	0.30	0.060	ug/L		11/27/20 10:36	11/28/20 03:06	1

Client Sample ID: Indian Trail 6

Date Collected: 11/21/20 08:36

Date Received: 11/25/20 15:00

Lab Sample ID: 680-191950-73

Matrix: Water

Method: 200.8-1994 R5.4 - Metals (ICP/MS)

Analyte	Result	Qualifier	RL	MDL	Unit	D	Prepared	Analyzed	Dil Fac
Lead	0.10	J	0.30	0.060	ug/L		11/27/20 10:36	11/28/20 03:23	1

Client Sample ID: Indian Trail 7

Date Collected: 11/21/20 08:40

Date Received: 11/25/20 15:00

Lab Sample ID: 680-191950-74

Matrix: Water

Method: 200.8-1994 R5.4 - Metals (ICP/MS)

Analyte	Result	Qualifier	RL	MDL	Unit	D	Prepared	Analyzed	Dil Fac
Lead	0.090	J	0.30	0.060	ug/L		11/27/20 10:36	11/28/20 03:20	1

Client Sample ID: Indian Trail Comp

Date Collected: 11/21/20 08:41

Date Received: 11/25/20 15:00

Lab Sample ID: 680-191950-75

Matrix: Water

Method: 200.8-1994 R5.4 - Metals (ICP/MS)

Analyte	Result	Qualifier	RL	MDL	Unit	D	Prepared	Analyzed	Dil Fac
Lead	0.30		0.30	0.060	ug/L		11/27/20 10:36	11/28/20 03:09	1

Client Sample ID: Indian Trail Soup

Date Collected: 11/21/20 08:45

Date Received: 11/25/20 15:00

Lab Sample ID: 680-191950-76

Matrix: Water

Method: 200.8-1994 R5.4 - Metals (ICP/MS)

Analyte	Result	Qualifier	RL	MDL	Unit	D	Prepared	Analyzed	Dil Fac
Lead	2.3		0.30	0.060	ug/L		11/27/20 10:36	11/28/20 03:17	1

Client Sample ID: Indian Trail Braze

Date Collected: 11/21/20 08:47

Date Received: 11/25/20 15:00

Lab Sample ID: 680-191950-77

Matrix: Water

Method: 200.8-1994 R5.4 - Metals (ICP/MS)

Analyte	Result	Qualifier	RL	MDL	Unit	D	Prepared	Analyzed	Dil Fac
Lead	1.5		0.30	0.060	ug/L		11/27/20 10:36	11/28/20 03:42	1

